



# Packaging

## THE SPECIALIST

Heavy wire, fine wire and extra-fine wire  
Shaped wire

J. G. Dahmen & Co. GmbH & Co. KG  
Karl-Arnold-Straße 45-73  
58644 Iserlohn  
Germany  
Tel. +49 2371 9580-0  
Fax +49 2371 9580-58  
[www.dahmen-wire.de](http://www.dahmen-wire.de)  
[sales@dahmen-wire.de](mailto:sales@dahmen-wire.de)

# Packaging

d1 = Flange  
d2 = Barrel  
d3 = Bore  
L1 = Length  
L2 = Traverse

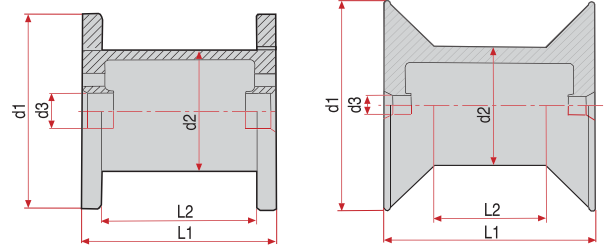

## Standard spools acc. to DIN 60264-2-1

No.	d1	d2	d3	L1	L2	Capacity approx. kg
63	63.0	40.0	11.0	63.0	49.0	0.30
80	80.0	50.0	16.0	80.0	64.0	1.00
100	100.0	63.0	16.0	100.0	80.0	2.00
125	125.0	80.0	16.0	125.0	100.0	3.00
160	160.0	100.0	22.0	160.0	128.0	7.50
200	200.0	125.0	22.0	200.0	160.0	15.00
250	250.0	160.0	22.0	200.0	160.0	22.00
355	355.0	224.0	36.0	200.0	160.0	40.00
500	500.0	315.0	36.0	250.0	180.0	75.00
500	500.0	315.0	127.0	350.0	280.0	150.00

## Biconical spools acc. to DIN EN 60264-5-1

HKK 76/45	63.0	43.5	16.0	60.0	34.0	0.40
HK 76/45	63.5	44.0	8.0	86.0	60.0	0.60
HK 76/45	63.5	44.0	16.0	86.0	60.0	0.60
HK 80/45/8	80.0	55.0	8.0	100.0	70.0	0.80
HK 80/45/11	80.0	55.0	11.0	100.0	70.0	0.80
HK 80/45/16	80.0	55.0	16.0	100.0	70.0	0.80
HKV 100/45	100.0	56.0	16.0	100.0	49.0	1.20
HK 100/59-160	100.0	75.0	59.0	160.0	91.0	2.00
HKV 125/45	125.0	71.0	16.0	125.0	65.0	3.00
HK 130/81-176	130.0	99.0	81.7	176.0	91.0	3.00
HKV 160/45	160.0	90.0	22.0	160.0	85.0	7.50

## Special spools

MF 40	40.0	25.0	8.0	90.0	70.0	0.20
MF 50	50.0	31.5	8.0	90.0	70.0	0.30
F 221	74.0	62.0	11.0	79.0	93.0	0.30
F 225	80.0	58.0	11.0	100.0	84.4	0.80
HK 76	63.4	44.0	16.0	86.3	76.0	0.45
S 100	100.0	80.0	64.5	150.0	135.0	1.80
P 3	130.0	80.0	20.0	110.0	90.0	3.60
P 5	160.0	90.0	20.0	114.0	90.0	5.50
P 10	200.0	90.0	25.0	134.0	110.0	10.00
P 15	249.0	110.0	30.0	140.0	110.0	17.00
B 10/17 plain	165.0	95.0	17.0	103.0	88.0	5.60
B 10/17 concave	165.0	95.0	17.0	103.0	88.0	5.60
B 10/47	165.0	95.0	47.0	103.0	88.0	5.60
250/400 (PT 45)	250.0	200.0	100.0	400.0	335.0	45.00
315/500 (PT 90)	315.0	200.0	100.0	500.0	425.0	90.00